

CONTROLLER RIDER'S GUIDE

ZEHUS

HUMAN PLUS

Get to know
your way to
ride *more.*



Contents

1	Get started	P 8
2	Set up	P 12
3	Riding	P 18
4	Battery care	P 22

Safety warnings

P 6

Safety warnings

DO NOT open the unit yourself. The Controller is maintenance-free and must be repaired only by qualified experts and only with original spare parts. Any unauthorized attempt to open the unit will void warranty claims.

DO NOT make any modification to the Controller.

DO NOT use the Controller without the protection covers for the charging port. Warranty is void if the it has being used without protecting the charging port.

Please observe all national regulations on registering and using e-bikes.

The Controller must not be subjected to direct mechanical impacts. There is a risk that the battery and the electronics will be damaged.

Protect the Controller system against severe heat, fire and immersing into water. Danger of fire and explosion.

Vapors can escape in case of damage or improper use of the Controller. Avoid contacts with those vapors, as they can irritate the respiratory system.

Charge the battery only with original Zehus battery charger. Damage can occur while using non original charging devices.

Keep the battery charger away from rain or moisture. Keep the battery charger clean. Danger of electric shock

Before any charging operation, check the battery charger status. If any damage is detected, DO NOT use the charger and contact a qualified retailer.

Do not operate the battery charger on flammable surfaces.

Vapors can escape in case of damage or improper use of the charger. Avoid contacts with those vapors, as they can irritate the respiratory system.

Keep the charger out of children reach.

1. Get started

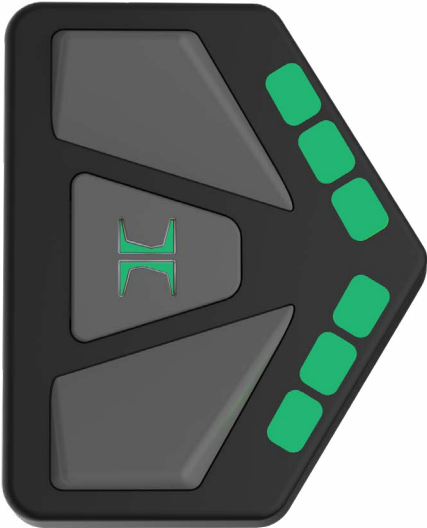

1.1 Features

The Zehus Controller is a portable and removable handlebar device that allows you to manage specific functions of the paired system:

- Activate the assistance
- Turn OFF the system
- Change power modes
- Activate K.E.R.S.
- Activate BOOST function
- Display state of charge, motor power, bike speed.

1.2 Functions

Zehus Controller has 3 buttons, 6 LED indicators and 1 RGB status LED. It also integrates a Buzzer that signals when it is turning on (single beep) or when it is turning off (double beep).

The Controller features one RGB led indicator to communicate its connection status and the its battery level.

Connection status:

- Blue slow blink
- Blue fast blink

Battery level:

- Green
- Orange

The Controller also features six leds to communicate specific riding parameters.

They are customizable from the Zehus App to display the Motor Power deploy, the motor battery

charge status, the speed and remain off. Beyond these, they show the boost activation, through a sequential blink of the three upper leds, and the regenerative braking activation through the sequential blink of the three lower leds.

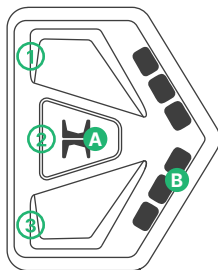

Buttons

1	Short Press:	Increase Power Mode
	Long Press:	Activate Boost
2	Short Press:	Activate The All In One assistance
	Long Press:	Turn on / turn off*
3	Short Press:	Decrease Power Mode
	Long Press:	Regenerative braking

**Attention: if the Controller is connected to The All In One, the turn of command turns off both devices.*

LED

A	Blue:	Slow blinking when waiting for connection
		Fast blinking when connecting
	Green:	Fixed when connected (battery >10%)
		Blinking when charging
	Yellow:	Controller low battery level (<10%)
B	Customizable through the Zehus App during the registration of the Controller and after in the Controller settings page	

2. Set up



Follow these steps to prepare your Controller to be paired and used while riding.

2.1 Charge

Charge the Zehus Controller before pairing it and use it for the first time. It takes 2 hours to fully charge, depending on the type of use, the battery can last up to 2 weeks.

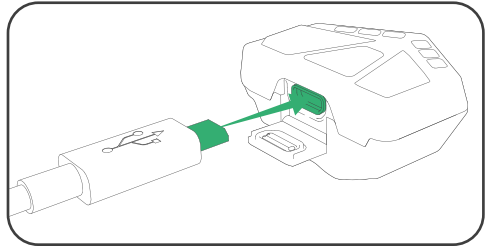

2.2 Pair

You can turn on your Controller by clicking on the mid button, a short beep will confirm your remote has been turned on.

To connect the Zehus Remote Controller to your All In One, start the pairing procedure from the Ecosystem page on the app, tap on Add device, then follow the registration procedure.

Note: please do not turn off the Controller until the last step of the registration procedure.

Note: previous firmware versions of the Controller did not feature the buzzer function. Please update the firmware if you do not hear the buzzer working properly.

Note: at the end of this procedure, The All In One will be turned off, please turn it on again to use it.

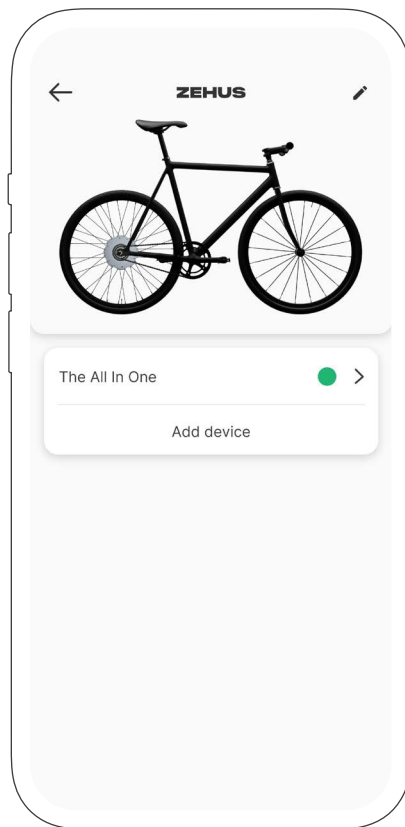



ADD NEW DEVICE

Zehus



Controller

Sigma



EOX VIEW 1300



ROX 2.0



ROX 4.0



ROX 11.1 Evo

Garmin



EDGE 830

CONFIGURATION

Do you have
the Zehus Controller?



[What is the Controller?](#)

No

Add

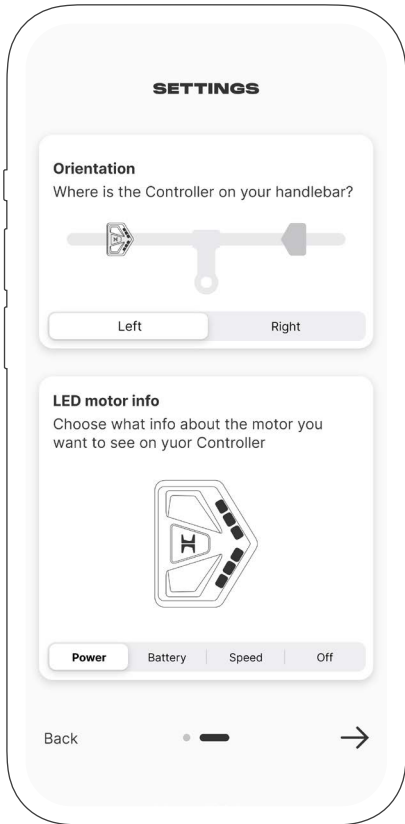

During the configuration you can set up the position of the remote controller on the handlebar and what to display on the six leds. These settings can be changed every time desired from the Controller page on the app.

The Controller will always auto-connect with your All In One every time that:

The All In One is turned on, the Controller is turned on and the Battery status of both devices is sufficient.

2.3 Mount

Thanks to the Controller support, once mounted on the handlebar, your remote will be in the perfect position for your thumb to press the buttons. You can decide to mount it either on the left handlebar or the right one. During Remote registration and configuration you will be able to specify the side you chose.

Firstly, to mount the Controller you have to place the support on the desired position on the handlebar of your bike, then insert the Controller as represented in figure, and rotate it in place to lock it.

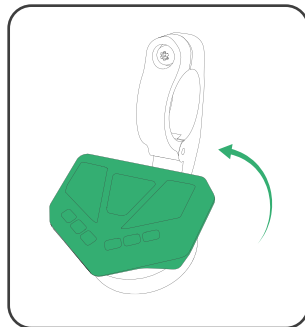
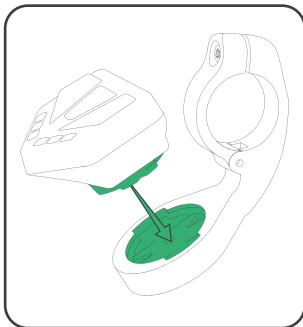
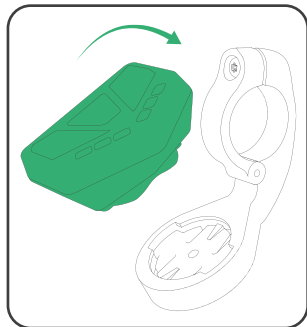
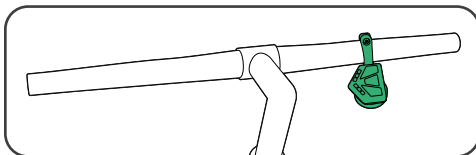
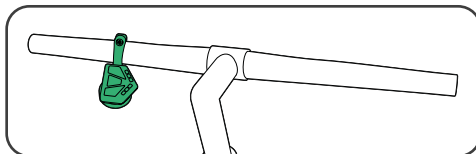

3. Riding

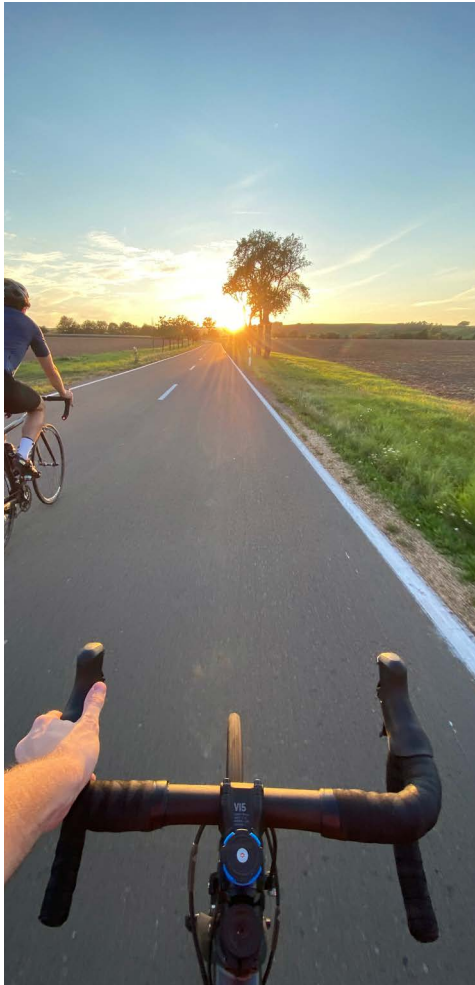

3.1 Functions

While riding you can perform this action with your Controller:

- Increase and decrease the power modes
- Activate the boost
- Activate K.E.R.S. while braking

3.2 Turn on and Turn off

Turn on the Controller pressing the central button, the buzzer sounds to confirm it is on, then the RGB central led indicates the connection status (1.1) and then its battery level (1.1)

Note: Turning on the Controller does not turn on the system, you have to switch them on separately through their specific procedures.

To turn off the Controller, long press the central button until you hear two buzzes and the 6 leds blink. If the Controller is connected with the motor this action turns off all the system.

3.3 System assistance activation

When the central led of the Controller is white, you need to activate the assistance of motor through a long press of the central button until you hear a buzz and the led is green.

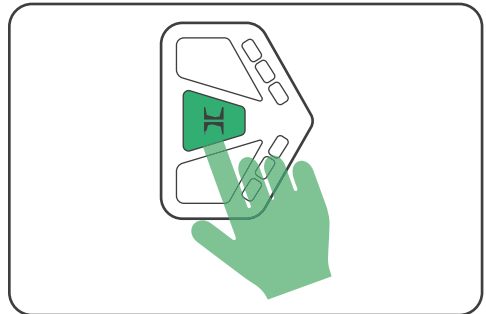
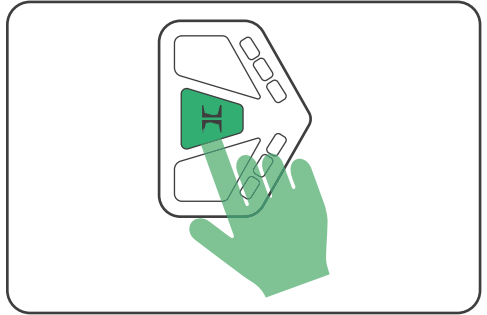

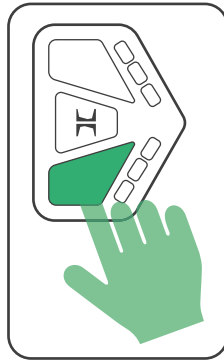
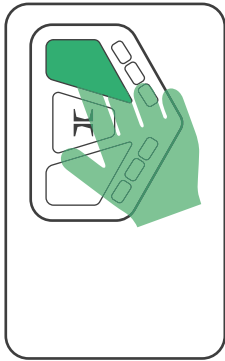

3.4 Change Power Modes

Through the up and down buttons on the Controller you can increase or decrease the power mode, while you are changing the mode on the leds appears the corresponding level.

3.5 Boost and K.E.R.S.

Through the Controller you can activate the Boost function or the K.E.R.S. function. To activate the boost long press the upper button, as feedback of the activation the 3 upper leds blink progressively.

To activate the Regenerative braking long press the lower button, as feedback the 3 lower leds blink progressively.

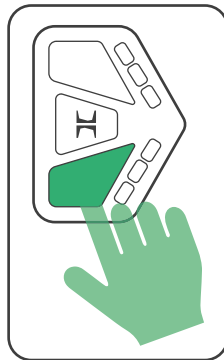
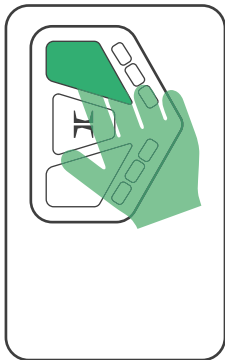

4. Battery care

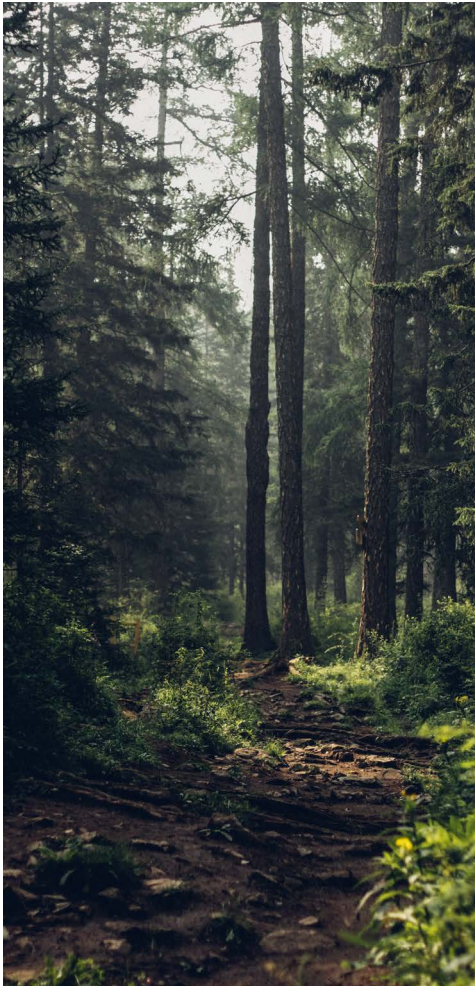

It is important to take care of the battery embedded in the Controller to maximize its durability and capacity.

4.1 Charging

Always charge the battery of your Controller to avoid full discharge that could damage its power.

4.2 Storage conditions

The Controller has to be stored at the right temperature. The battery life can be maximized by following the rules for correct storage and handling.

In case of malfunctioning your battery pack will have to be replaced. Please refer to a Eventure retailer to have your battery pack replaced.

Store the Controller in a well-ventilated location, dry if possible. Protect the it from moisture and water. The optimal storage temperature is +20°C and the bike must be stored between -40°C and +60°C. It is preferred not to leave the bike under the direct sunlight during hot summer days.

4.3 Transport

Items with internal battery packs are subject to Dangerous Goods Legislation requirements.

Private users can transport such undamaged items by road without further requirements.

When being transported by commercial users or third parties (e.g. air transport or FWD agencies), special requirements on packaging and labeling must be observed (e.g. ADR regulations). If necessary, an expert for hazardous materials can be consulted when preparing the item for shipping.

Dispatch the Controller only when the housing is undamaged.

Protect the charger connector with the provided closed nut in such a manner that the connector itself cannot be damaged or broken. Inform your parcel service that the package contains dangerous goods. Please also observe the possibility of more detailed national regulations. In case

of questions concerning transport of the Controller please refer to an authorized Eventure dealer. Bicycle dealers can also provide suitable transport packaging.

4.4 Disposal

The Controller and all its components should be sorted for environmental-friendly recycling.

Only for EC countries

According to European Guideline 2012/19/EU, electrical devices tools that are no longer usable, and according to European Guideline 2006/66/EC, defective or used battery packs/batteries The All In One must be collected separately and disposed of in an environmentally correct manner.



Disposal of Old Electrical and Electronic Equipment

This symbol indicates that the product complies with the European Directive 2012/19/EU.

(Applicable in the EU-member states)

The symbol indicates that this product shall not be mixed with unsorted municipal waste when disposed of. There is a separate collection system for waste electrical and electronic equipment. For further information please contact the competent municipal authorities or the retailer from which you purchased the product. Correct disposal ensures that waste electrical and electronic equipment is recycled and reused appropriately. It helps avoid potential damage to the environment and human health and to preserve natural resources.



This symbol indicates that the product contains an integrated battery which is subject to the European Directive 2006/66/EU and cannot be disposed of in normal household waste. It is advisable to take the appliance to a collection point or a service centre where a technician can remove the battery properly. Please check and abide by any regulations for disposing of electrical / electronic products in your local area to prevent any impact to the environment and possible damage to health.



Zehus s.p.a.

Viale Luigi Sturzo 45,

20154, Milano, Italy

Phone: +39 031 636001

support@zehus.it

www.zehus.it

Rev. 1.0 - 06/2023

The specifications on this document are subject to change at Zehus decision. Zehus assumes no responsibility for any claims or damages arising out of the use of this document, or from the use of modules based on this document, including but not limited to claims or damages based on infringement of patents, copyrights or other intellectual property rights.

HUMAN PLUS

ZEHUS